

Wireless Triple-Tech Detector

Quick Start Guide
V1.0.0



English

1 Checklist

2 Structure

No.	Name	No.	Name
1	Photosensitive sensor	7	Wall mount screw hole
2	Camera	8	Corner mount screw hole
3	IR light	9	Tamper switch
4	Indicator	10	Battery compartment
5	Rotation bracket hole	11	Detection range adjustment switch
6	Pole mount bracket hole	12	Power switch

3 Installation

3.1 Power on the Detector

- When inserting the batteries, make sure that they are all charged to the same level.
- When inserting the batteries, align the "+" symbols on the battery to those on the detector.

3.2 Adding the Detector to the Hub and Testing Signal Strength and RF-HD

- Make sure that you have added the hub to the DMSS or Dolyнк Care app.
- Make sure that the version of the DMSS app is 1.99.620 or later, and the hub is 2.000.0000000.0.R.20231220 or later.

3.3 Field of Detection

- a: Detection range.
b: Effective detection trigger.
c: Installation position (not recommended).

When installing and using the detector, make sure there are no objects partially or fully obscuring the detector's field of view.

3.4 Installing the Detector

Adjust the detection range according to actual needs and test results.

Scan the QR code on the package to receive the user's manual for more information on the device and its installation procedures.

3.5 Anti-Masking Test

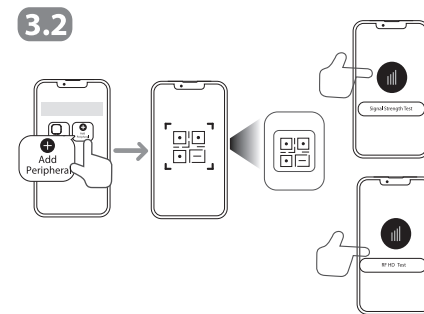
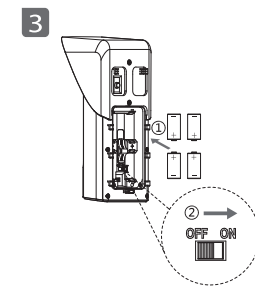
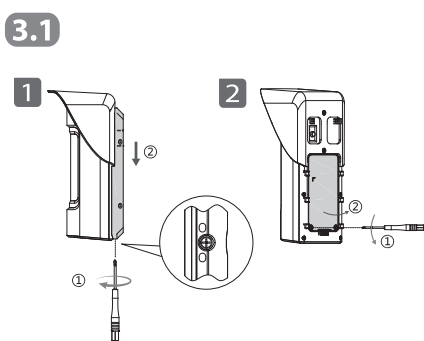
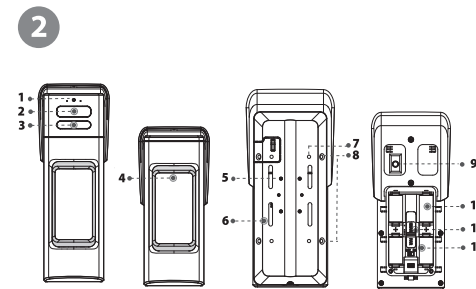
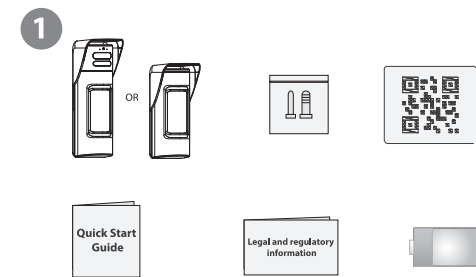

3.3

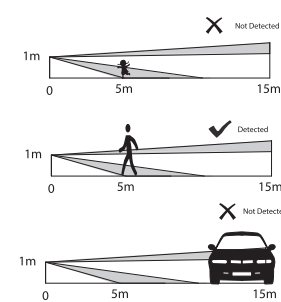
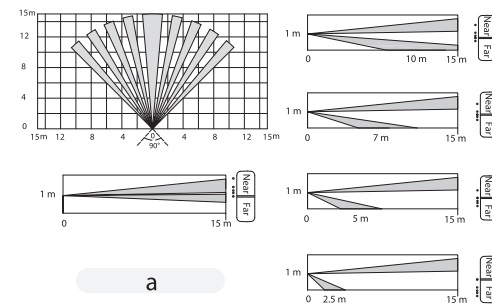

b

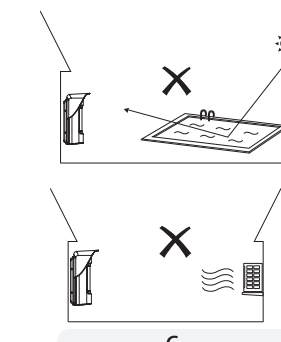

c

3.4

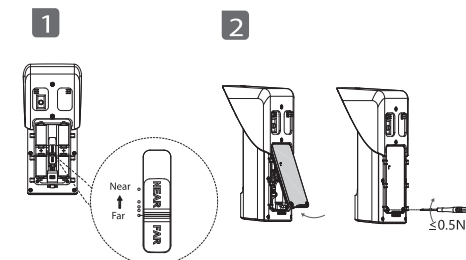

3

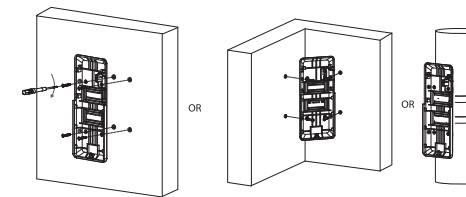

4

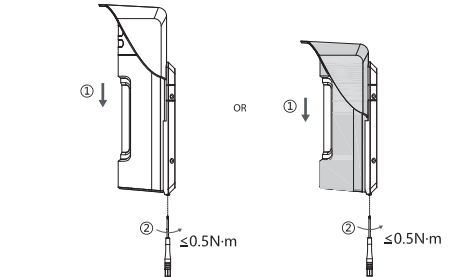

3.5

